

Kaba AWM

Access & Workforce Management







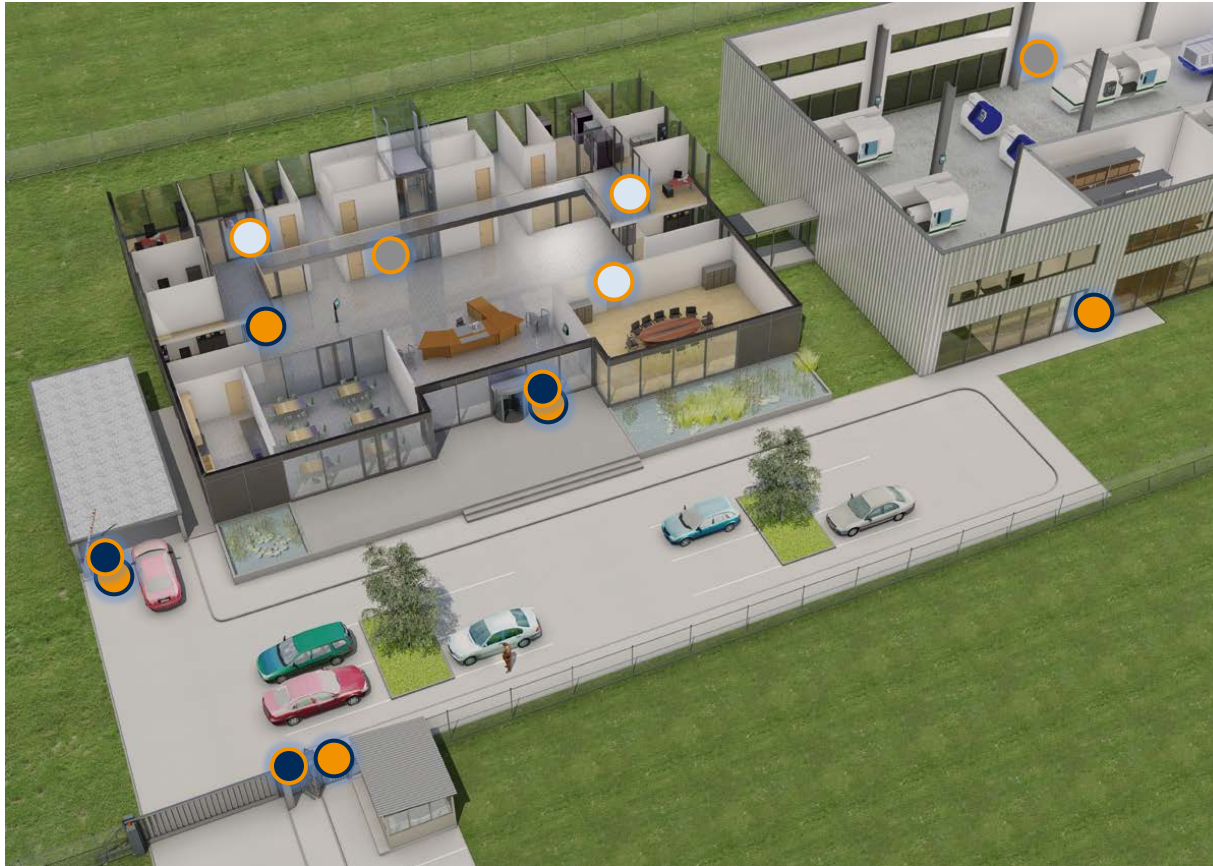

Agenda

KABA[®]

- > Kaba EAC (Electronic Access)
- > Kaba WFM (Work Force Management)
- > Kaba Hardware portfolio



-  Online access control
-  Standalone access control (CardLink) / mechanical locking systems
-  Security and revolving doors / barriers
-  Time and shoppe-floor data collection

Total Access Solutions

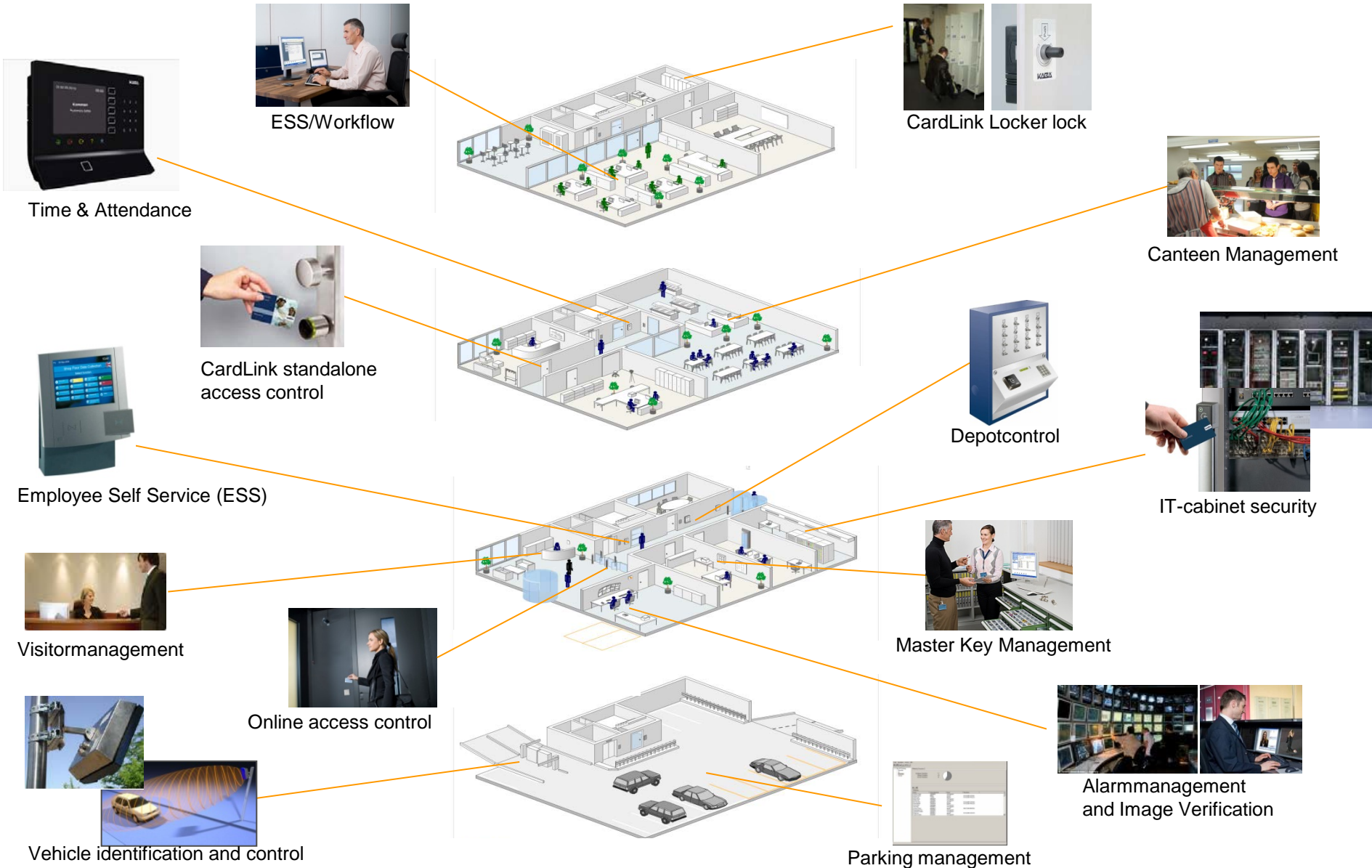

Time & Attendance



ESS/Workflow

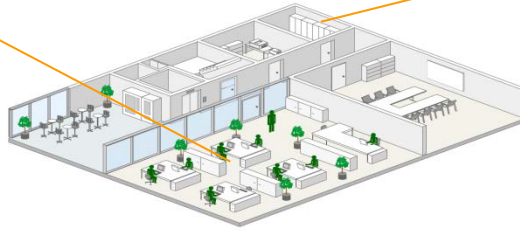

CardLink Locker lock



Canteen Management



CardLink standalone access control

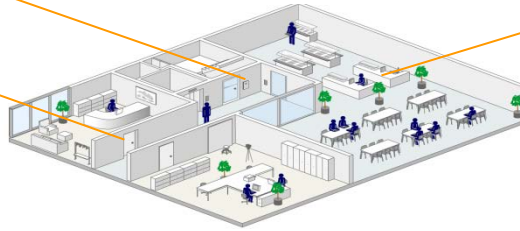

Depotcontrol



IT-cabinet security



Employee Self Service (ESS)



Visitormanagement

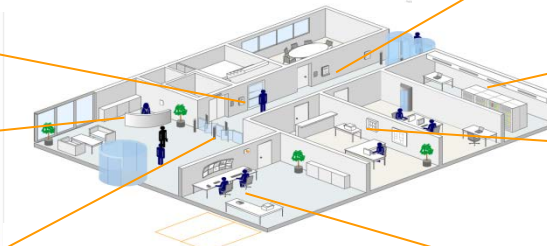

Master Key Management



Online access control



Vehicle identification and control

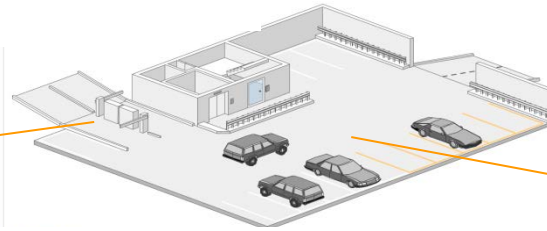

Parking management



Alarmmanagement and Image Verification



Agenda

KABA[®]

- > **Kaba EAC (Electronic Access)**
- > Kaba WFM (Workforce Management)
- > Kaba Hardware portfolio



Agenda

KABA[®]

- > **Kaba EAC (Electronic Access)**
 - Kaba Exos (Access + T&A System)
 - Kaba CardLink
 - Kaba evolo (standalone Access System)
- > Kaba WFM (Workforce Management)
- > Kaba Hardware portfolio

- The Kaba exos 9300 access management system is an access management solution for companies with **employees**, **visitors** and **contractors**.
- Kaba exos 9300 **monitors** and **organizes** access to **buildings**, **departments** and **rooms**.
- Kaba exos 9300 can be scaled to suit customer specifications and is equally suitable for local **SMEs** and international, networked **corporate groups**.



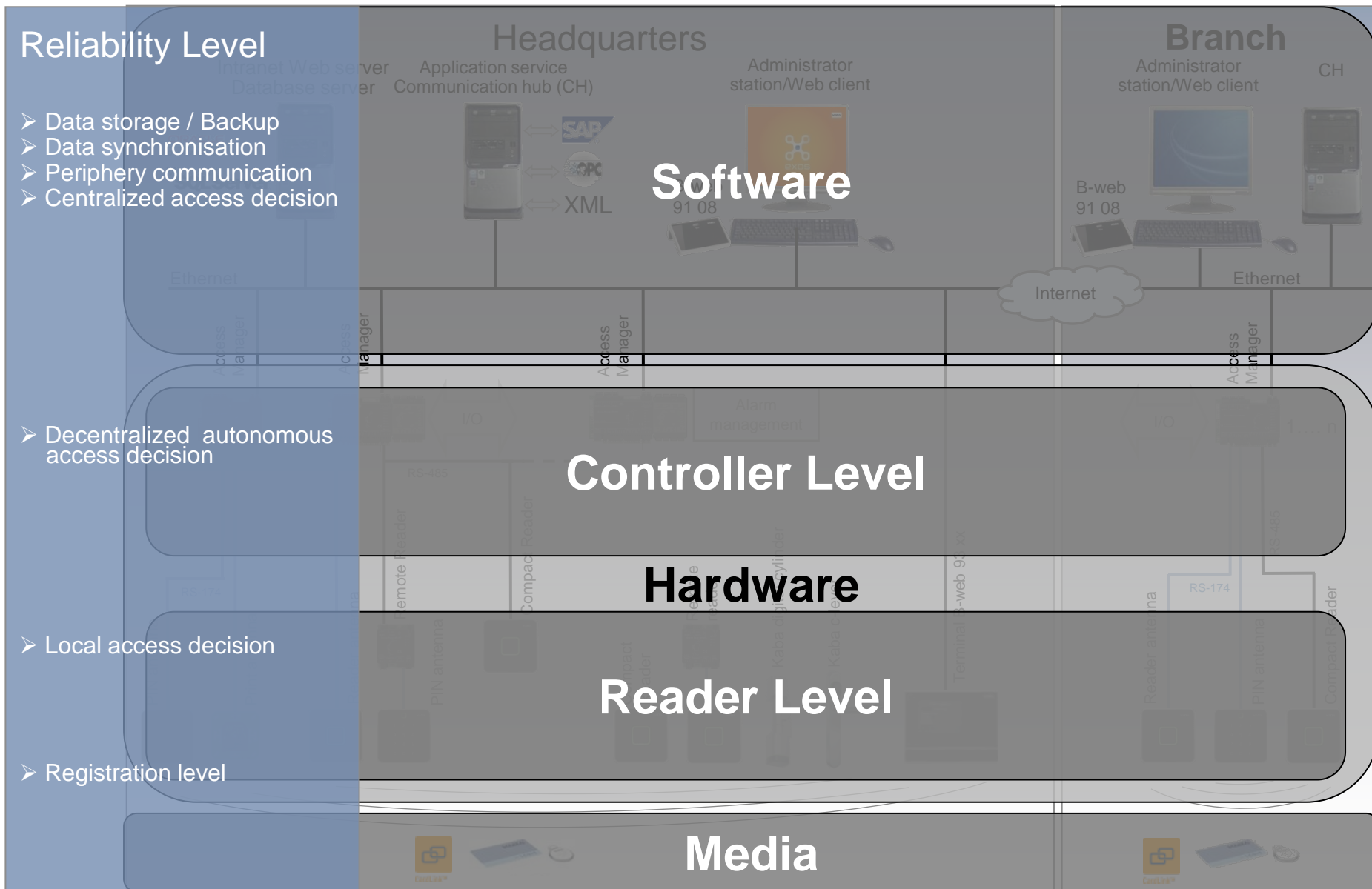

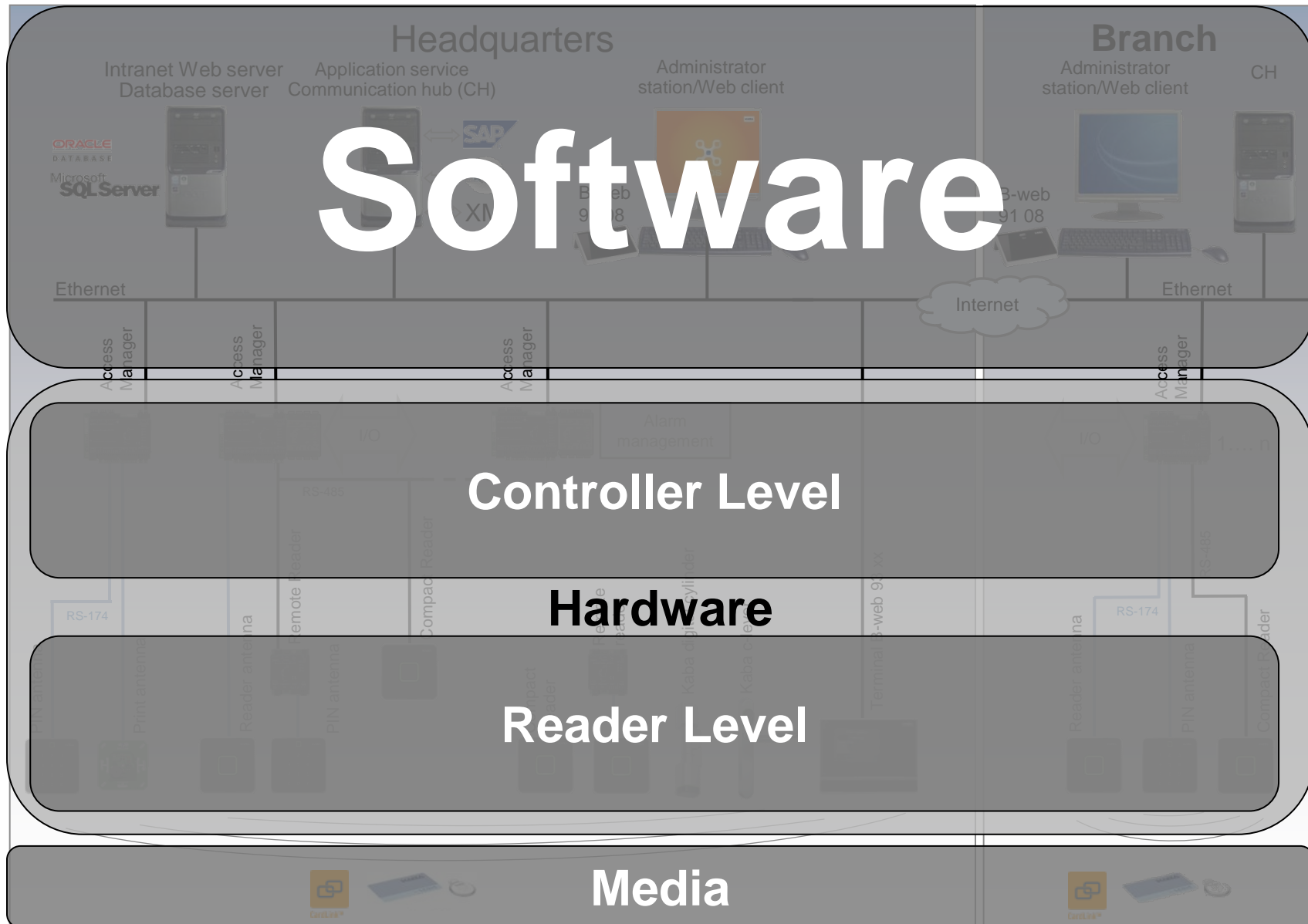

Overview exos 9300 management system

exos 9300 software modules

	System	People	Media	Access	Alarms	IT-Integration	WFM
Applications	System Management	Staff Data Management	Badge Management	Access Control	Alarm Management	LDAP Interface	B-COMM
	Multi-User System	Visitor Management	Badge Production	Parking Management	Alarm zone Management	Single sign-on	Time & Attendance
	Tenant Management	Contractor Management	Badge Prog. (Segments)	Logbooks/ Reports	OPC Server	Control/ Event Interf.	Workflows (Web, email)

Integration of different access and data points

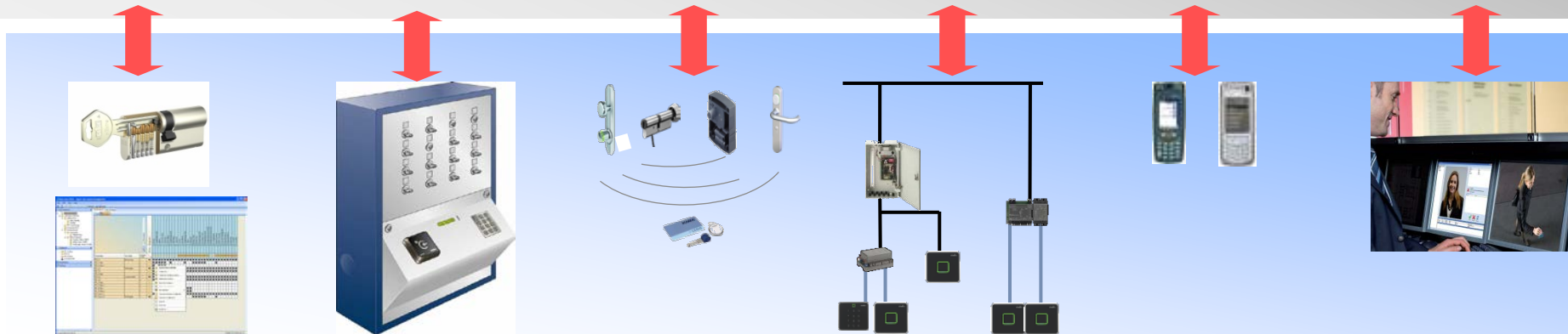

- Supported operating systems



- Supported databases



- Data exchange (DE)
 - Technology OPC or XML
 - Real-time data exchange
 - Facility management
 - Alarm management
 - Full network integration
 - Status presentation and operation of Access points
 - Alarm annunciation and confirmation
 - Export of log data
- Typical interfaces (e.g.)
 - Winguard (Advancis)
 - BIS (Bosch)
 - Honeywell
 - TOPSIS (Siemens)
 - GEMOS (Elasoft)



Aan Datum/ Tijd	Bevestig Datum/ Tijd	Naam	Omschrijving
19-8-2004 08:40:37	0	Rotterdam I: BR Control	RDR10004 Regelbaar OFFLINE
19-8-2004 08:40:37	0	Rotterdam I: BR Control	RDR10003 Com 4 kaart OFFLINE
19-8-2004 08:40:37	0	Rotterdam I: BR Control	RDR10002 Com 4 kaart OFFLINE
19-8-2004 08:40:37	0	Rotterdam I: BR Control	RDR10001 Com 4 kaart OFFLINE
19-8-2004 08:40:37	0	Rotterdam I: Toegang	KABA Communicatie ALARM
19-8-2004 08:39:02	0	Rotterdam I: BR Control	RDR10004 Wachdog ALARM
0	0	Rotterdam I: Toegang	Deur Kantoor BSS, Door open too lang
0	0	Rotterdam I: Toegang	Deur Kantoor BSS, Door closed again
0	0	Rotterdam I: Toegang	Deur Kantoor GPRS, Door closed again
0	0	Rotterdam I: Toegang	Deur Gang richting Kantoor, Door closed again
0	0	Rotterdam I: Toegang	Deur Gang richting Laadkunta, Door open too long
18-8-2004 14:37:53	0	Rotterdam I: Toegang	KABA Communicatie ALARM

Integrated Building Management System/Physical Security Information Management

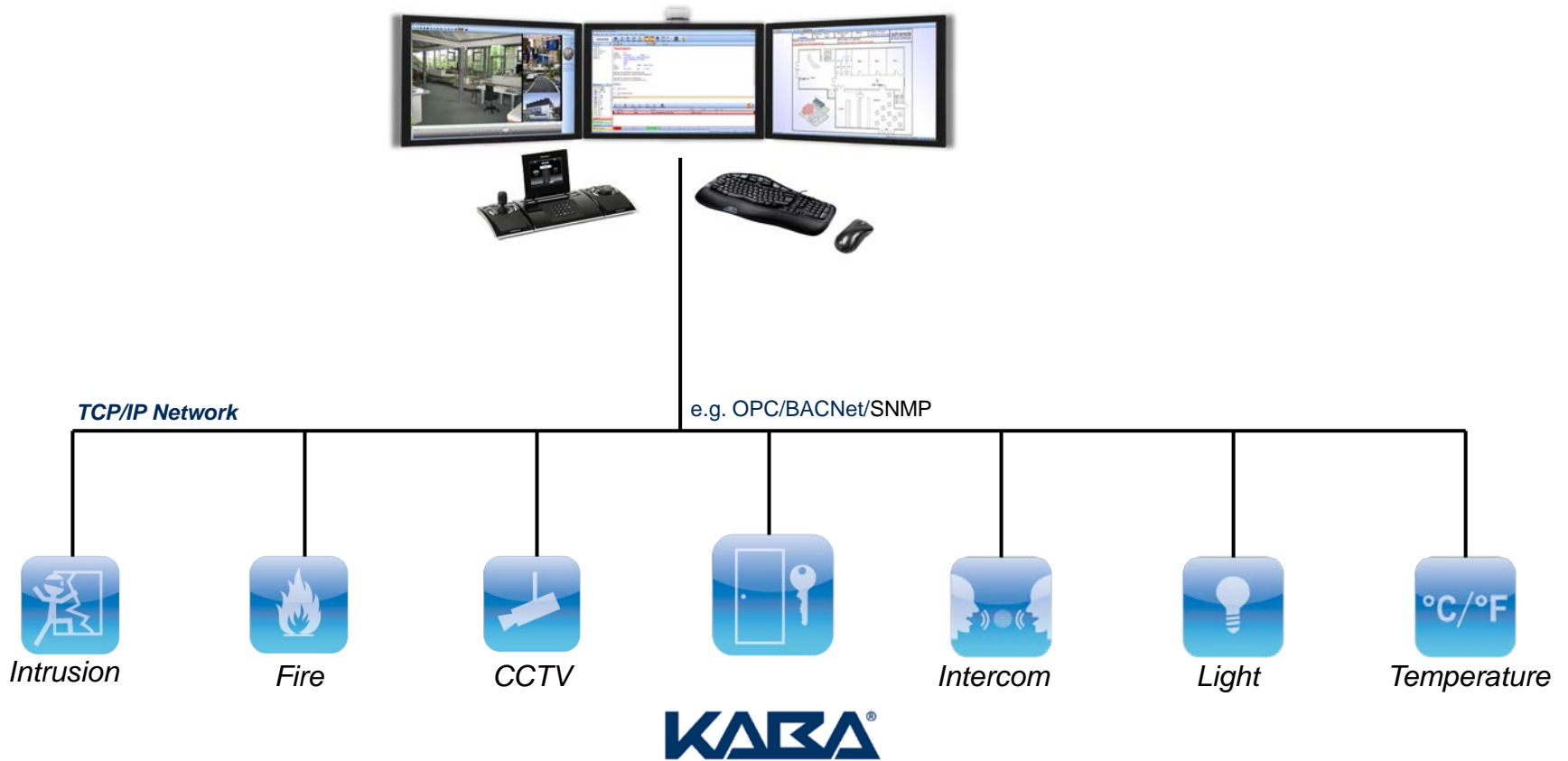

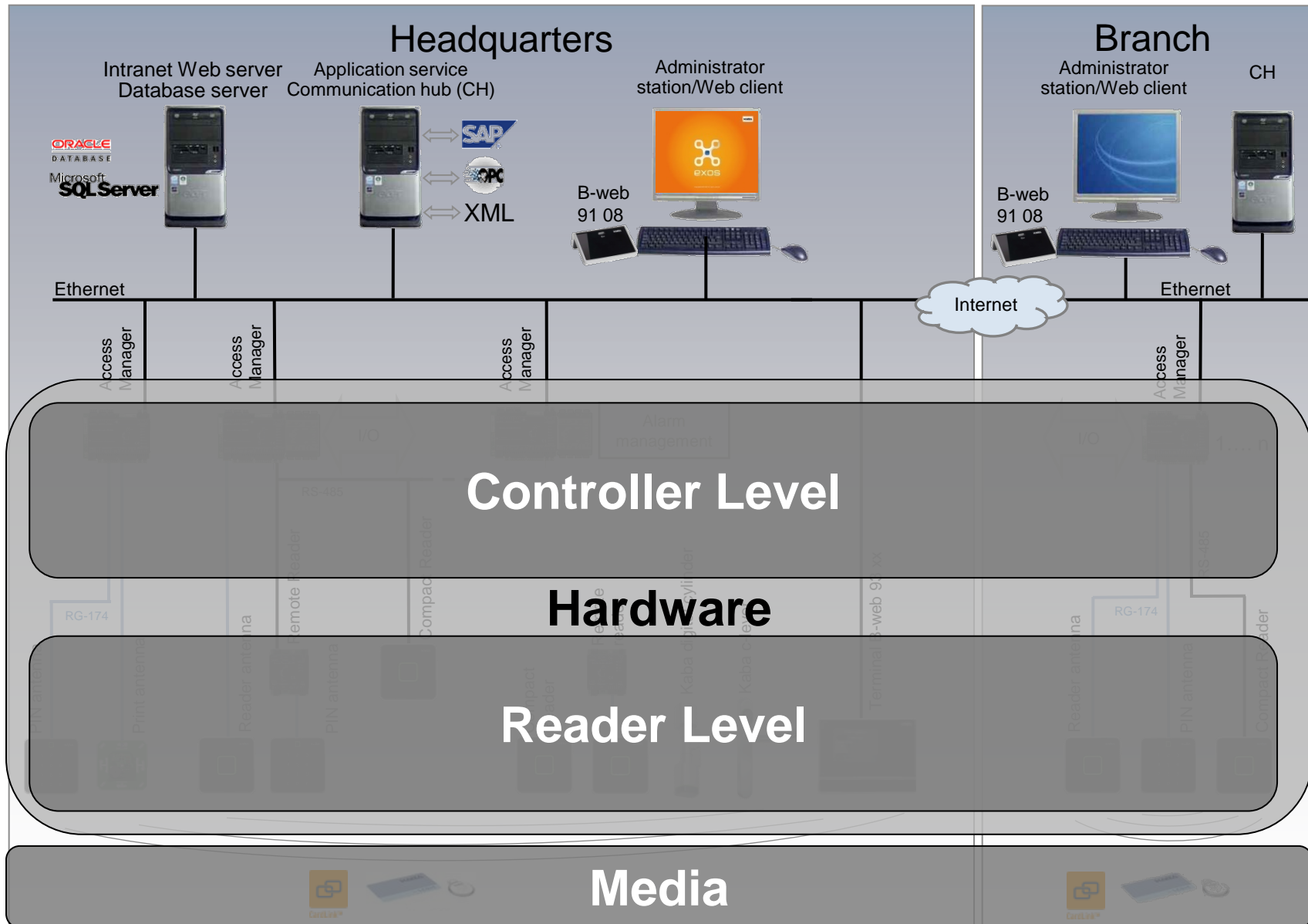

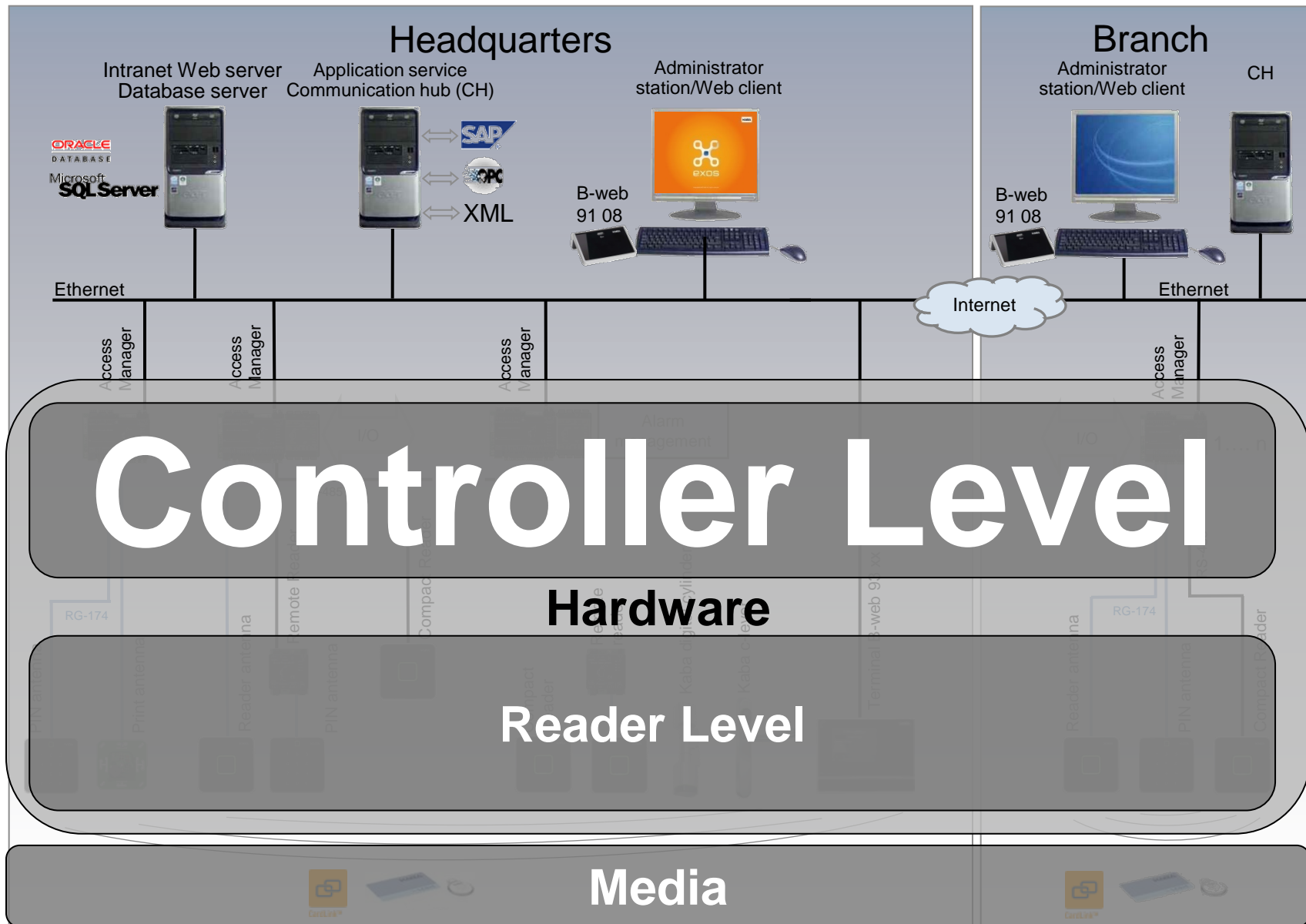

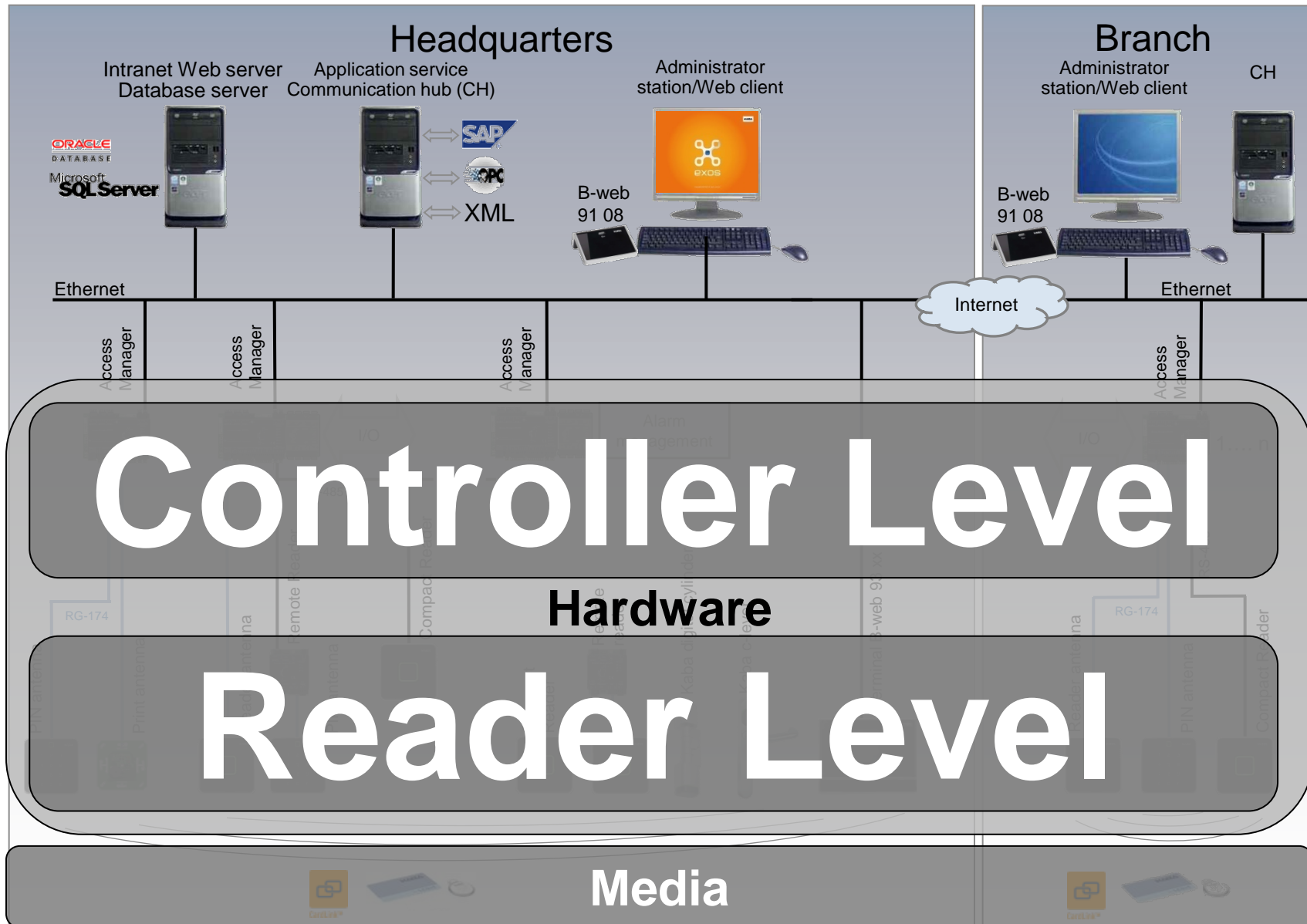

Kaba exos Release 3.1



Intranet Web server
Database server

ORACLE
DATABASE
Microsoft
SQL Server



Headquarters
Application service
Communication hub



Administrator
station/Web client



B-web
91 07

Ethernet

Existing Kaba exos
LEGIC periphery

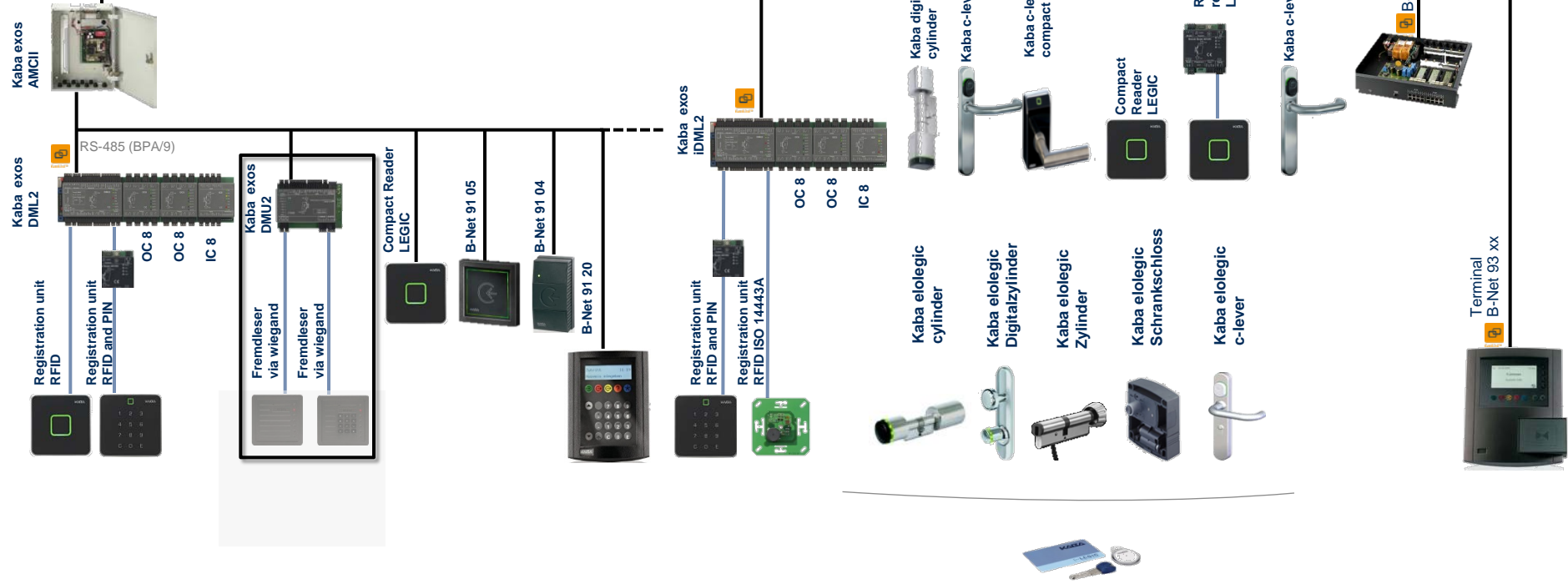

LEGIC

MIFARE

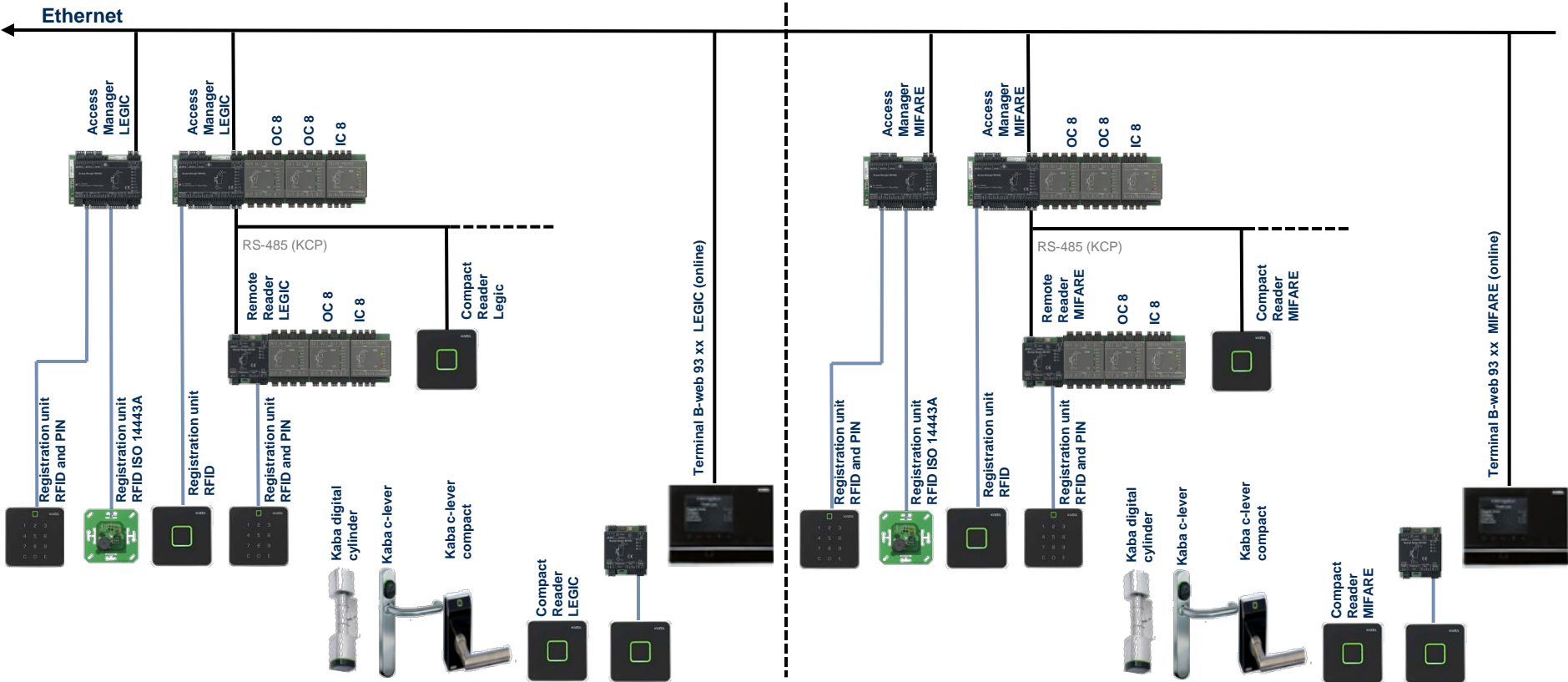



Functions:

- CardLink validation/devalidation
- CardLink update
- Lift control (max 150 floors)
- Alarm zones (analog AMC)

RG 174*

- When using badges max. 30m
- Diameter 2.67mm
- Shield: braided

RG 174*

RS-485

RS-232

RS-232

1

2

1..8

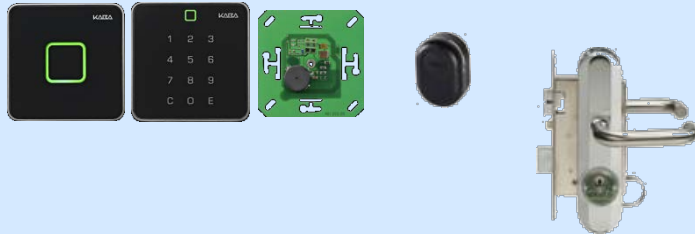

Compact Reader



Remote Reader

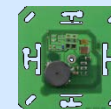

Registration Unit + PIN

Other readers, e.g. for wide area access solutions:

- Nedap TRANSIT
- Balogh Hyper X

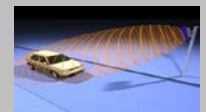

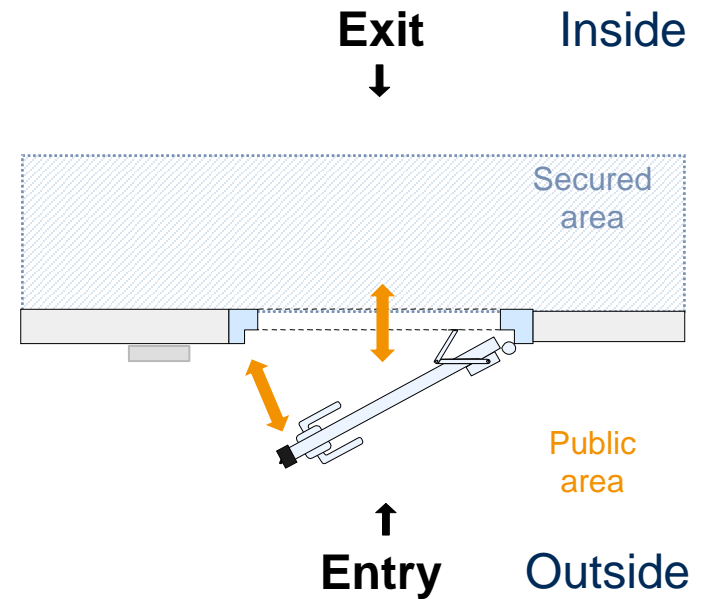
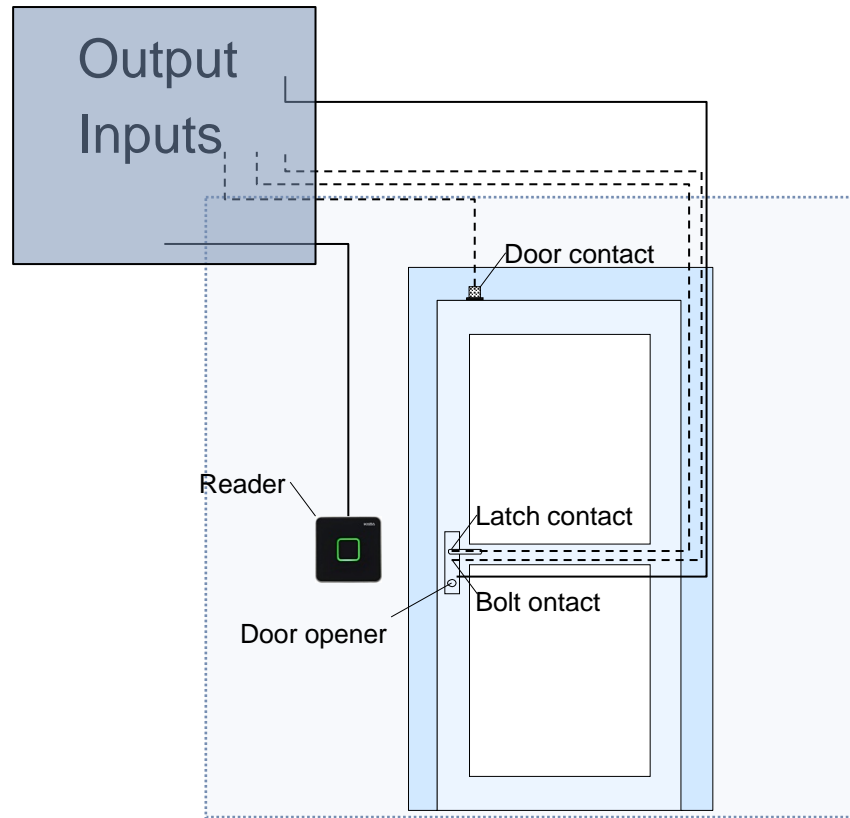

- Door contact: Door status → open or closed
- Bolt contact: Bolt status → extracted or retracted
- Door status → closed or locked
- Latch contact: Authorized opening

- Up to 50'000 cards
- Autonomus decision
- Usage of existing cabling (retrofit)

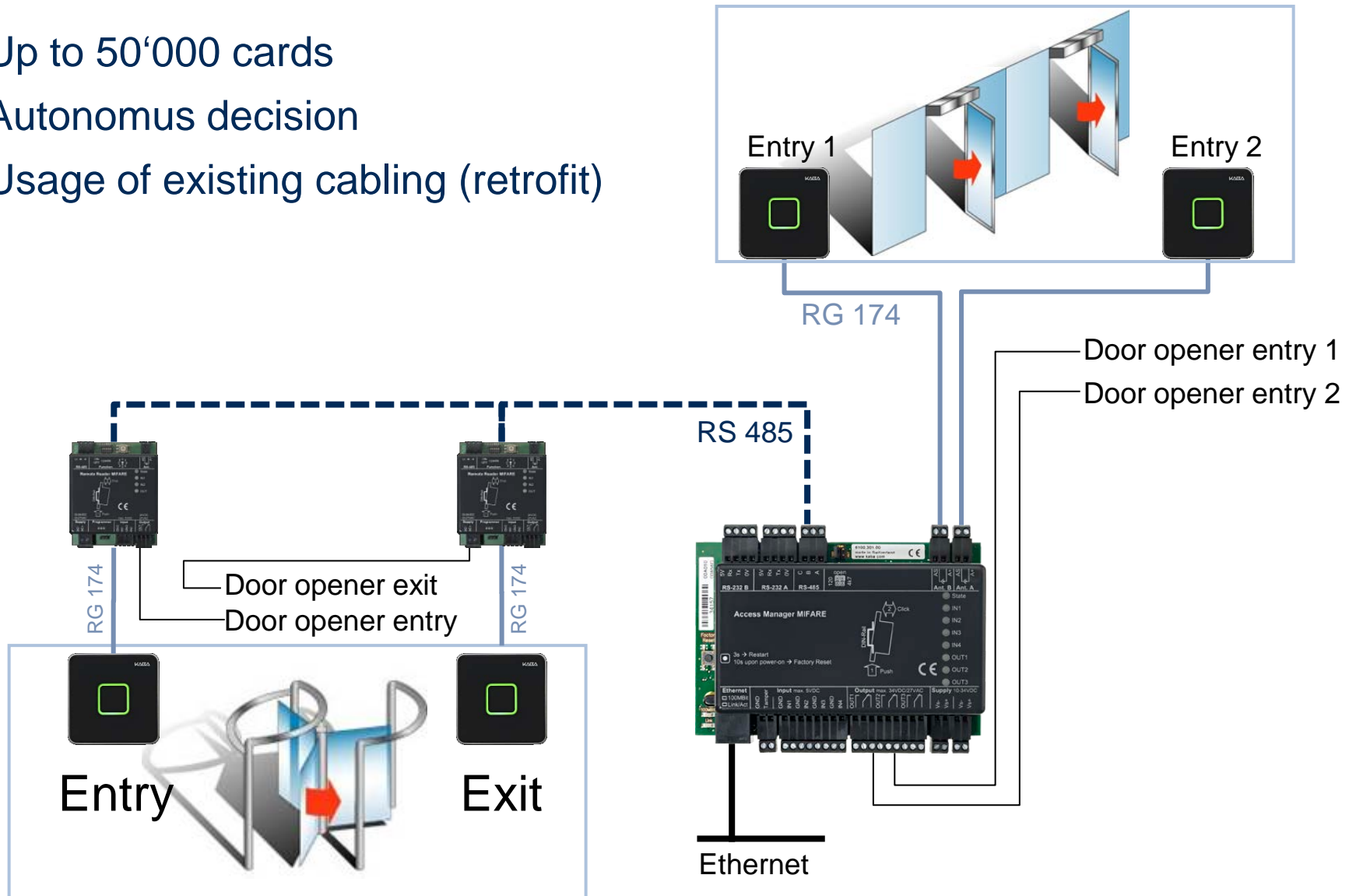

- Access Manager + IC8 + OC8 + OC8
 - 4 + 8 binary inputs
 - 3 + 8 + 8 relays
- Access Manager + 9xOC8
 - 4 + 72 binary inputs
- Installation:
 - Inside and outside applications in secured areas
 - DIN hat rail mounting

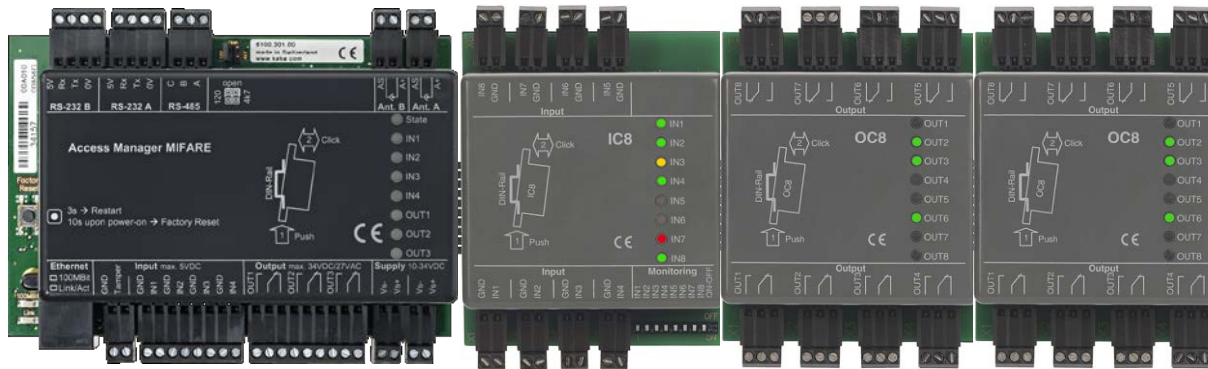

- 2 monitored binary inputs
1 relay
- CardLink validation/devalidation
- Installation:
 - inside and outside applications in secured areas
 - DIN hat rail mounting

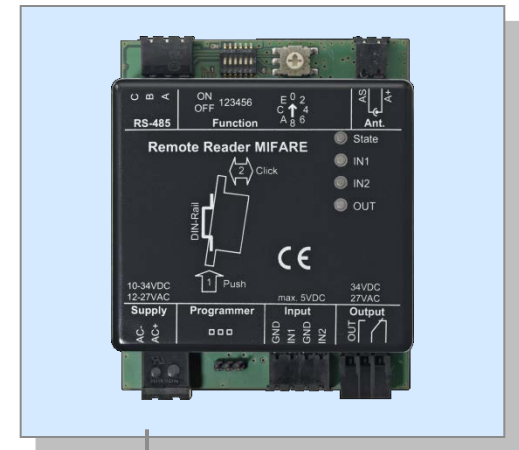

- when using badges max. 30m
- diameter 2.67mm
- shield: braided

1

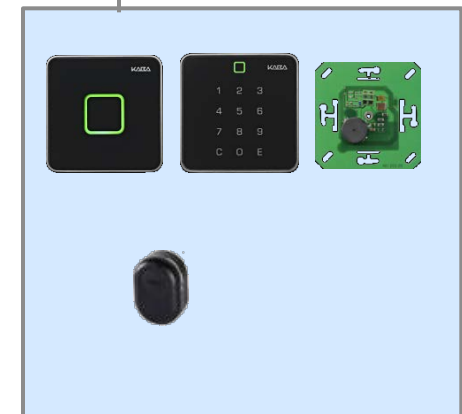

- 2 monitored binary inputs
1 relay
- CardLink validation/devalidation
- Installation:
 - inside and outside applications in secured areas
 - DIN hat rail mounting
- Remote Reader + IC8 + OC8 + OC8
 - 2 + 8 binary inputs
 - 1 + 8 + 8 relays

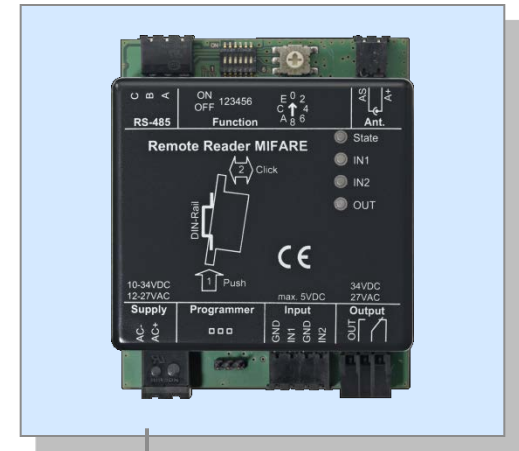

- RG 174*
- 1
- when using badges max. 30m
 - diameter 2.67mm
 - shield: braided

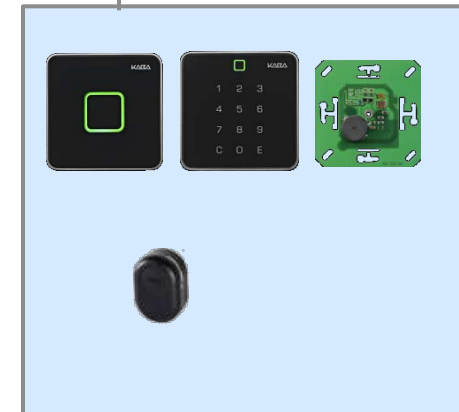

Customer benefits:

- Registration unit with integrated MIFARE or LEGIC antenna designed for use either under normal conditions or in metallic environment
- Two-colour light symbol (red-green) for signalling operating status and access decision, buzzer for acoustic signalling of access decision
- Efficient wiring and commissioning due to innovative quickwire™ technology, cable connection at rear or spacer frame



Rear panel

- Simple installation by connecting to Access Manager or Remote Reader via one coaxial cable (incl. activation of LED and buzzer)

- **Change to security requirement online:**

- Using quickwire, simple registration unit replacement without change to wiring

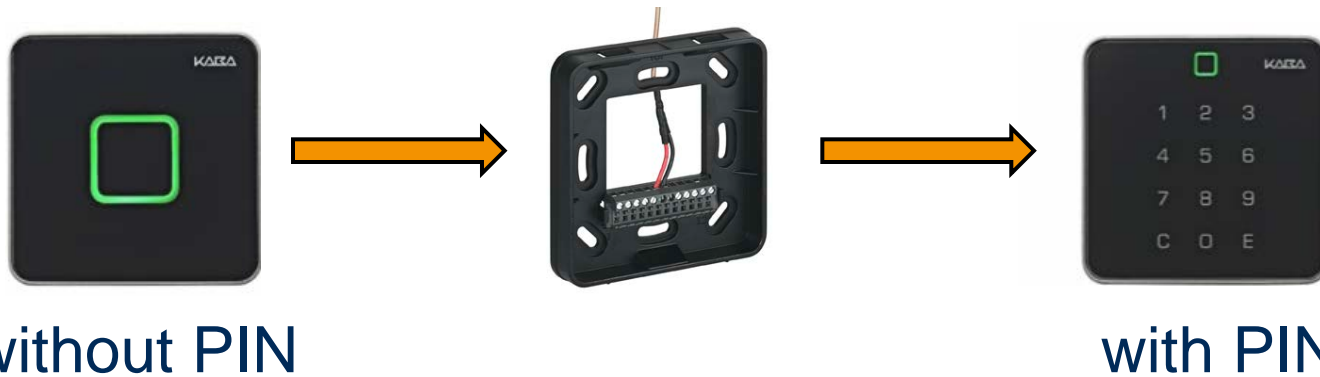

- without PIN

with PIN

Customer benefits:

- Reader with integrated Mifare/LEGIC antenna
- Connection to access manager via isolated RS-485 interface
- 2 non-monitored inputs for door opener key/door handle contact, and frame contact
- 1 door opener relay
- 1 bridge contact for external tamper monitoring (optional)
- Offline functionality as with Remote Reader:
 - Only site key check
 - Door management according to configuration
 - Max. 2000 events



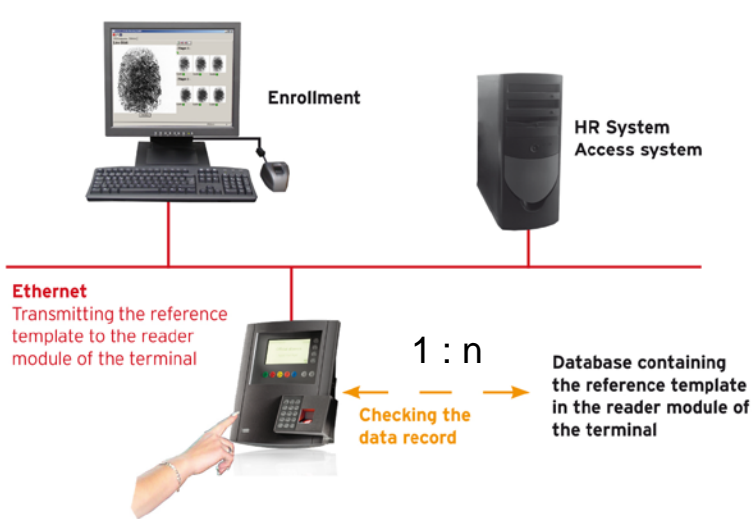

Identification



Verification





- Three sizes of biometric FP storage capacity: 500/3000/5000 people
Unlimited number of people in verification mode (template on card)
- 5 different biometric operating modes, including identification and verification, to suit individual customer needs
- Excellent recognition performance and increased security through additional PIN code input (if required)
- Alternative booking methods such as keypad entry or RFID reader for people with less defined biometric features

- Important **keys remain in the secure area**
- Traceability of who was given which key when
- Integrated management and control
- Management of **issue authorizations** by means of a profile or additional rights
- **Logging** of issue and return
- **Key depot** for 16, 32 and 64 positions can be selected

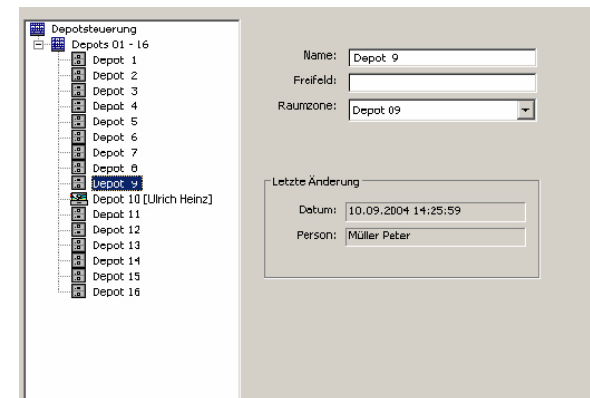

- Recording or checking **working time, job data** and **access authorizations** – exactly where and when they are due
- Bookings are **online** or **offline**
- The data of the mobile device are read out by means of a **docking station** or **radio communication** (W-LAN, GPRS) and transferred via network to the B-Net mobile server



Access control integration

- Car plate recognition
 - Integration of Nedap AVI ANPR camera – Supports all European and other license plates
 - Car plate serves as access credential for employees
 - ‘Virtual’ user media that contains alphanumeric license plate number must be configured beforehand in system
 - Batch input allows reading of alphanumeric credentials – can also be used for integrating barcode or equivalent
- ✓ For automatic access to parking and buildings with vehicles, including in/out control



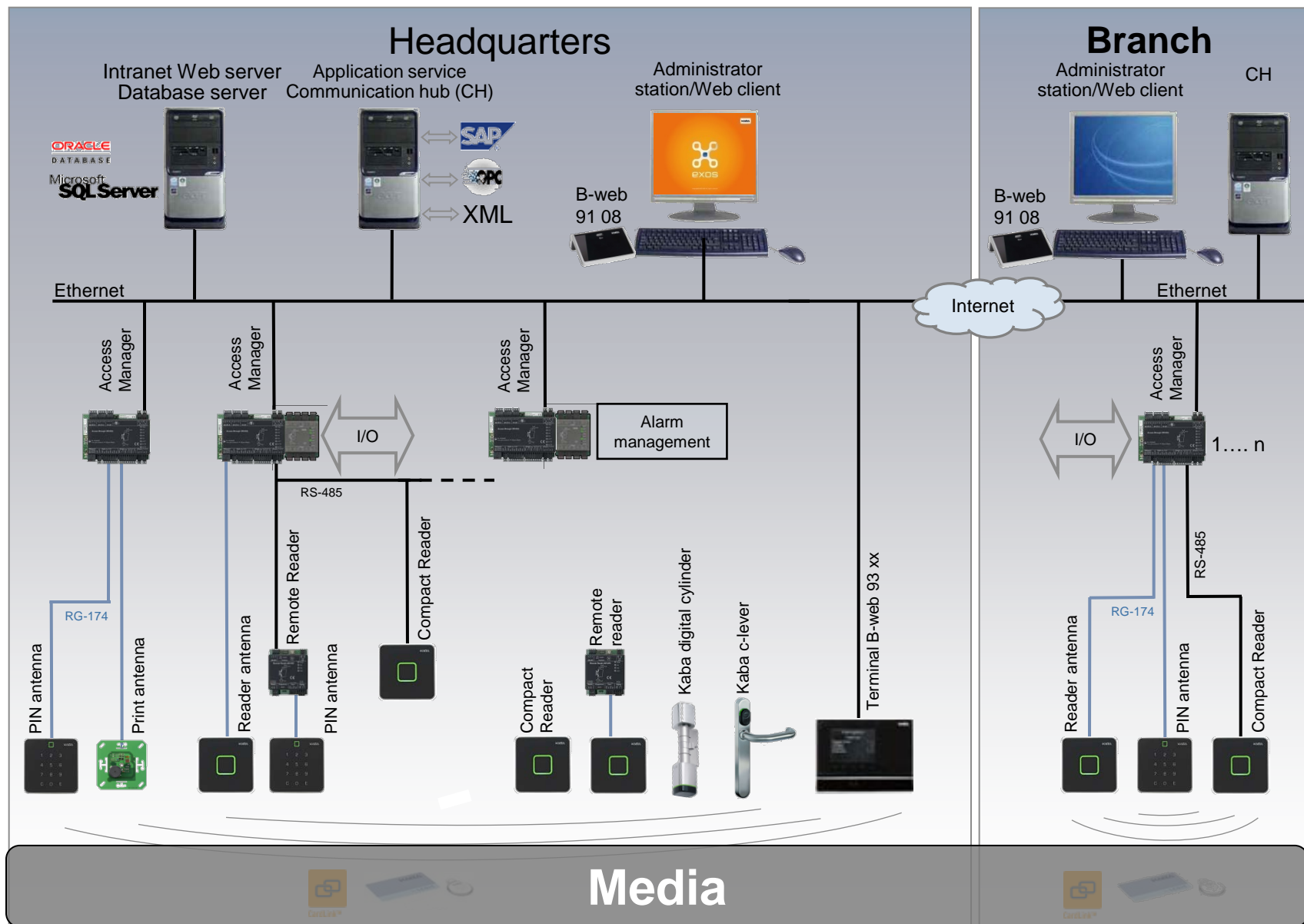

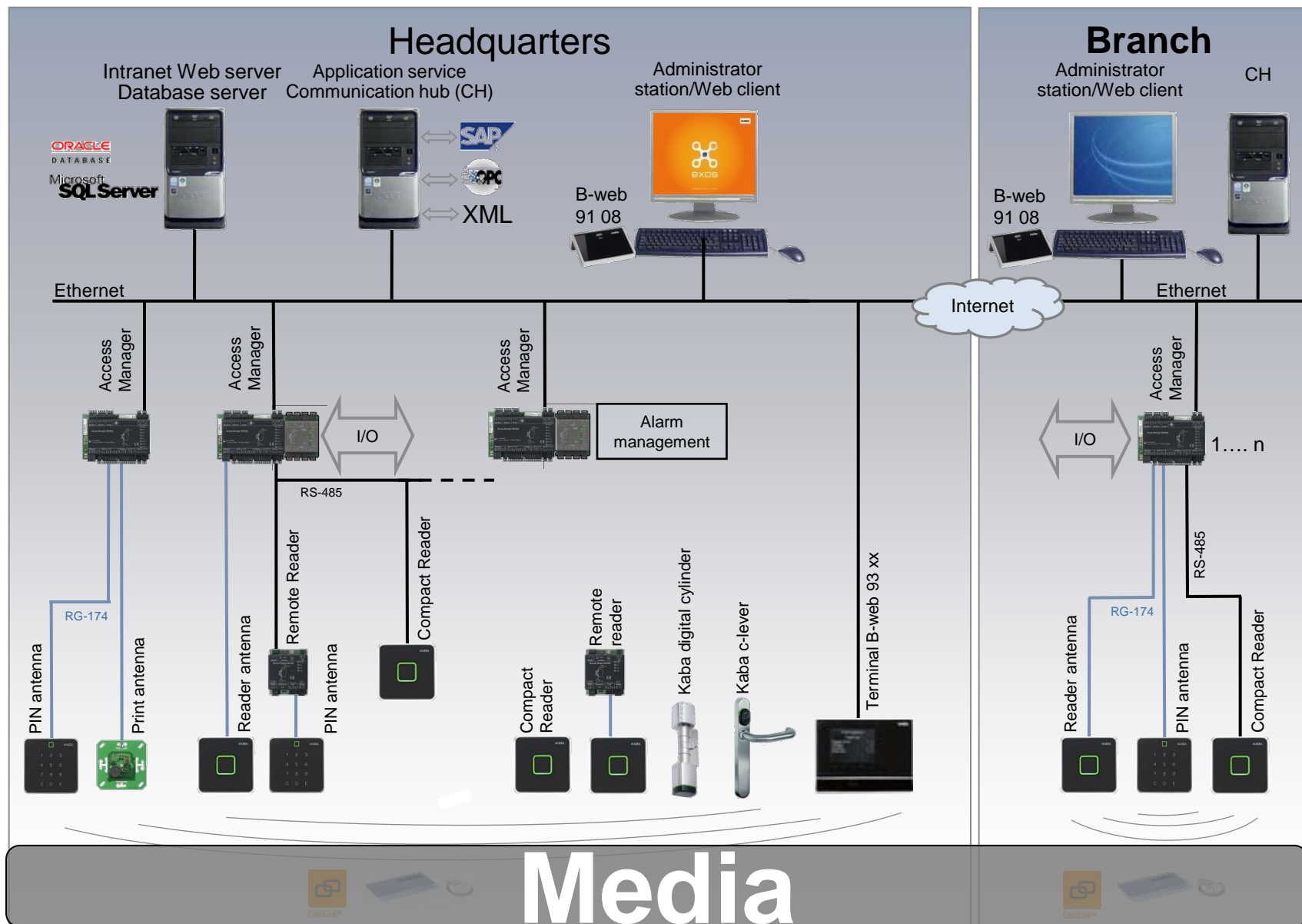

RFID – the common credential

Standalone access control



Online access control



Biometrics



Time and shop-floor data collection



PC authorization reader



Key depot



Card Collector



Doors and gates



Document management



Cashier systems



Vending machines



Agenda

KABA[®]

- > **Kaba EAC (Electronic Access)**

 - Kaba Exos (Access + T&A System)

 - Kaba CardLink**

 - Kaba evolo (standalone Access System)

- > **Kaba WFM (Workforce Management)**

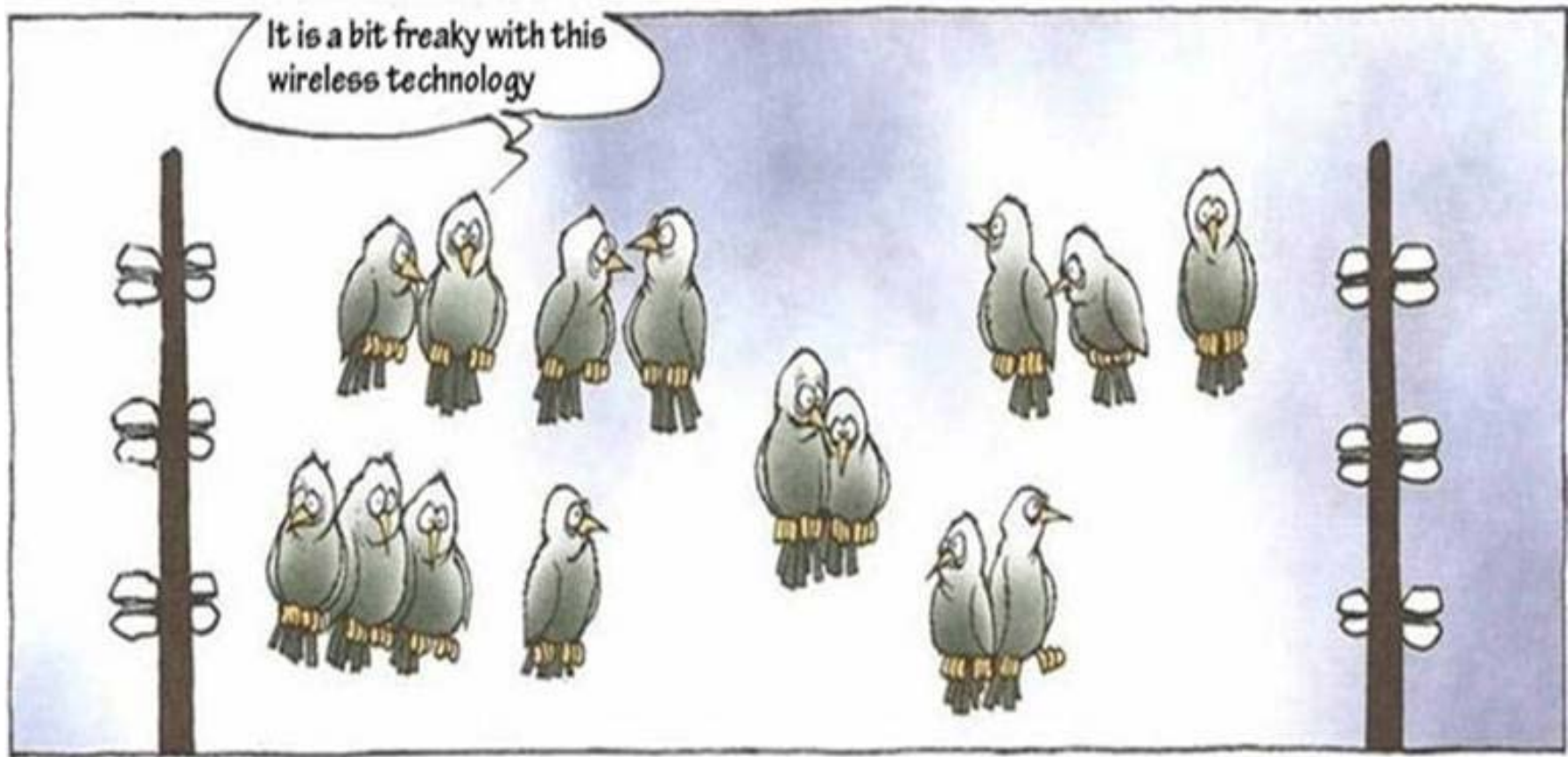

COPYRIGHT : MORTEN INGEMANN

The access rights are stored in the standalone components

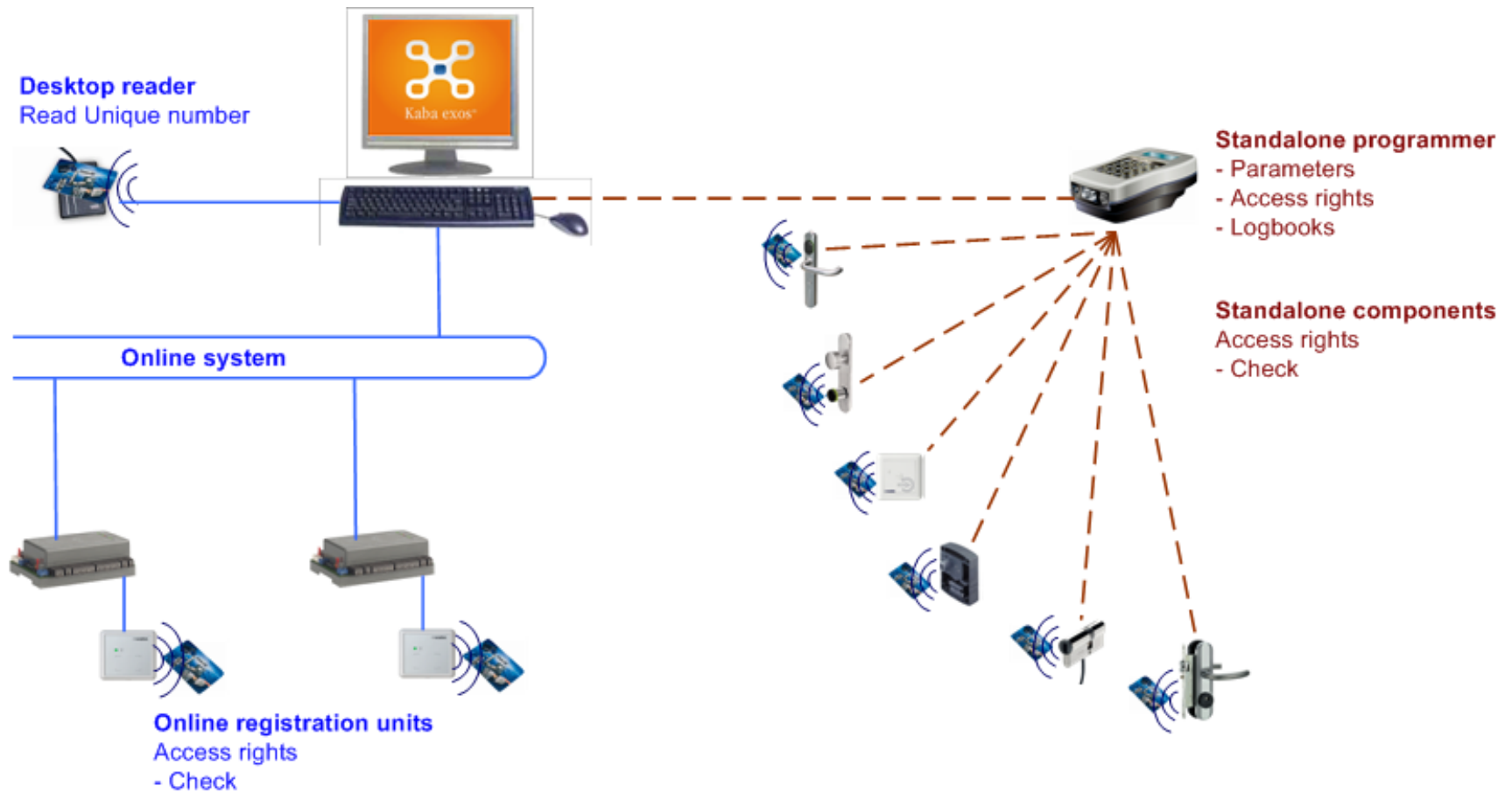

The access rights are stored on the media

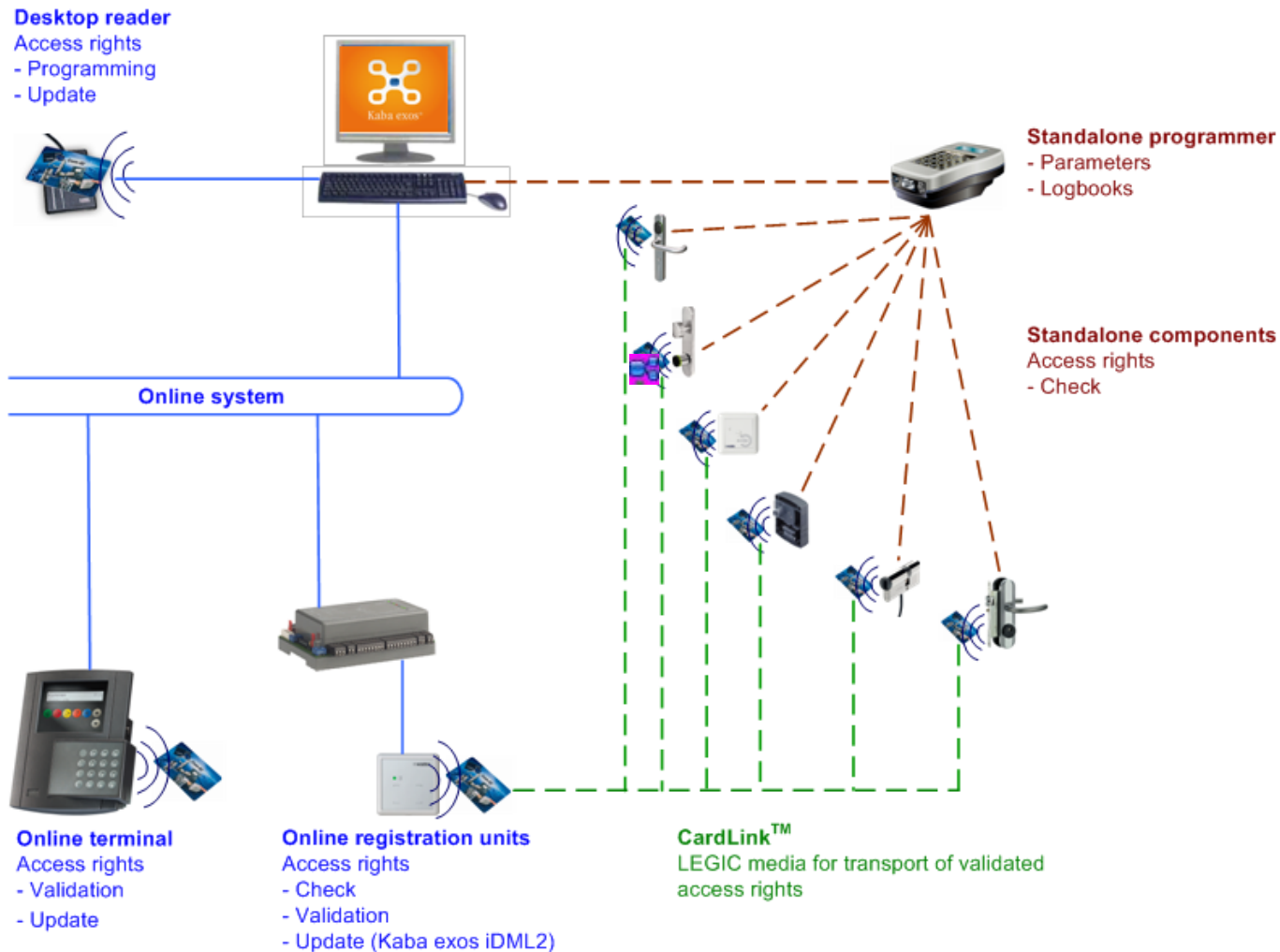

The access rights are stored on the media

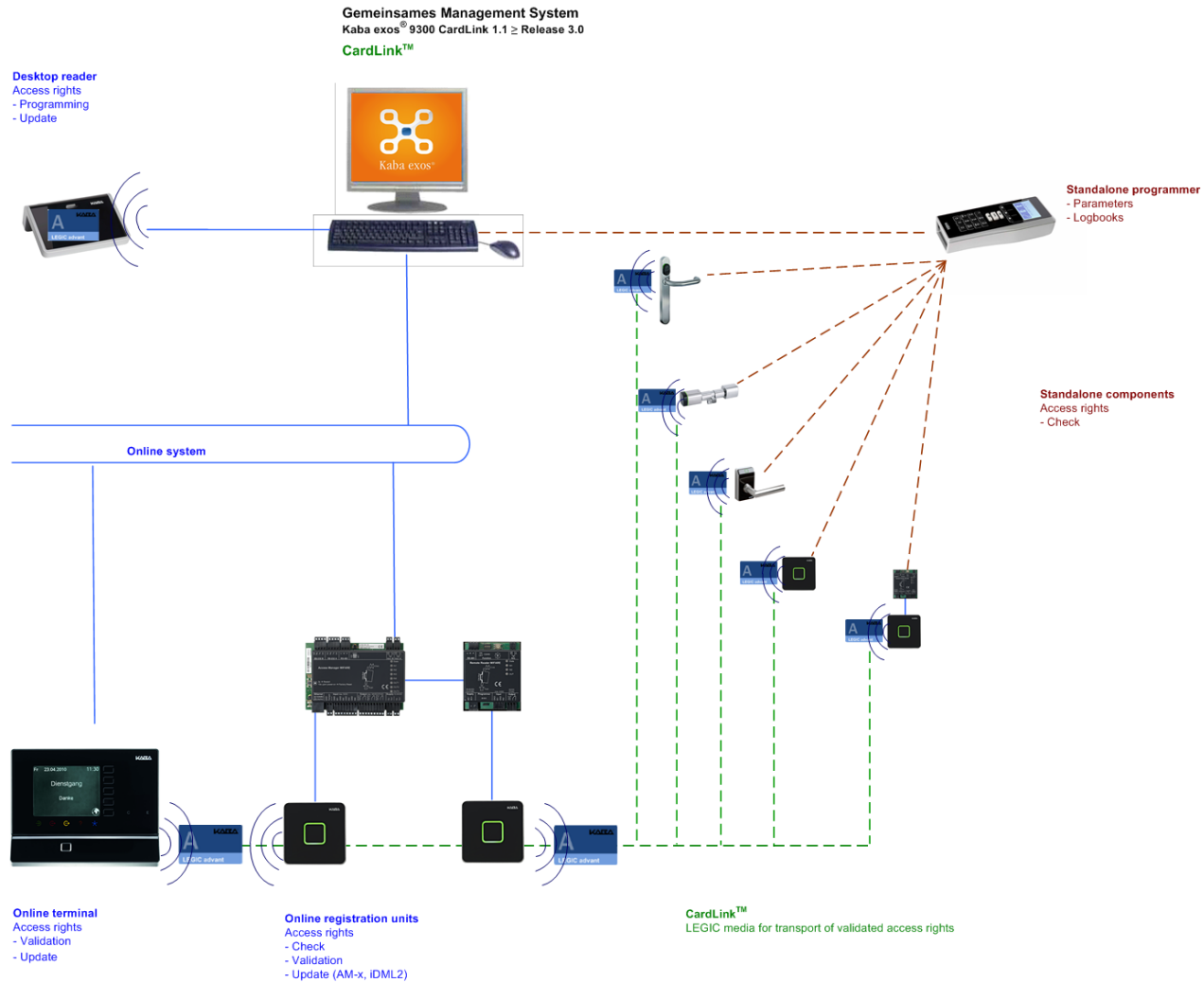

Kaba CardLink Components

- For MIFARE Classic/DESFire and LEGIC
- Wireless programming via NFC
- Firmware update possible



Driver	Lever	
Requirement for a modern, appealing design	New, rewarded look and design of the components	
Reduction of installation work	Simplified installation of the components	
Easy door solution for the inside area	No cabeling necessary	
Cost-oriented purchasing of standalone components	Lower costs in comparison to “online” system	
Reduction of „Total Cost of Ownership“ (TCO)	Higher battery lifetime of the standalone components 1 Card for online and standalone access control! Manage alle access rights and components in 1 software (exos 9300)	



Agenda

KABA[®]

> **Kaba EAC (Electronic Access)**

Kaba Exos (Access + T&A System)

Kaba CardLink

Kaba evolo (standalone Access System)

> Kaba WFM (Workforce Management)

> Kaba Hardware portfolio



Kaba terminal



Kaba digital cylinder

Kaba c-lever

Kaba c-lever compact

Kaba reader

Kaba user card



Kaba evolo manager



Kaba desktop reader



Kaba programmer 1460





Agenda

KABA®

- > Kaba EAC (Electronic Access)
- > **Kaba WFM (Work Force Management)**
- > Kaba Hardware portfolio



Agenda

KABA[®]

- > Kaba EAC (Electronic Access)
- > **Kaba WFM (Work Force Management)**
 - Kaba B-COMM / B-COMM ERP
- > Kaba Hardware portfolio

Level 1



Level 2

Applications for T&A, AC, SFDC

Level 3

Communication

Level 4



System Configuration for PC Solution

Logitime
international

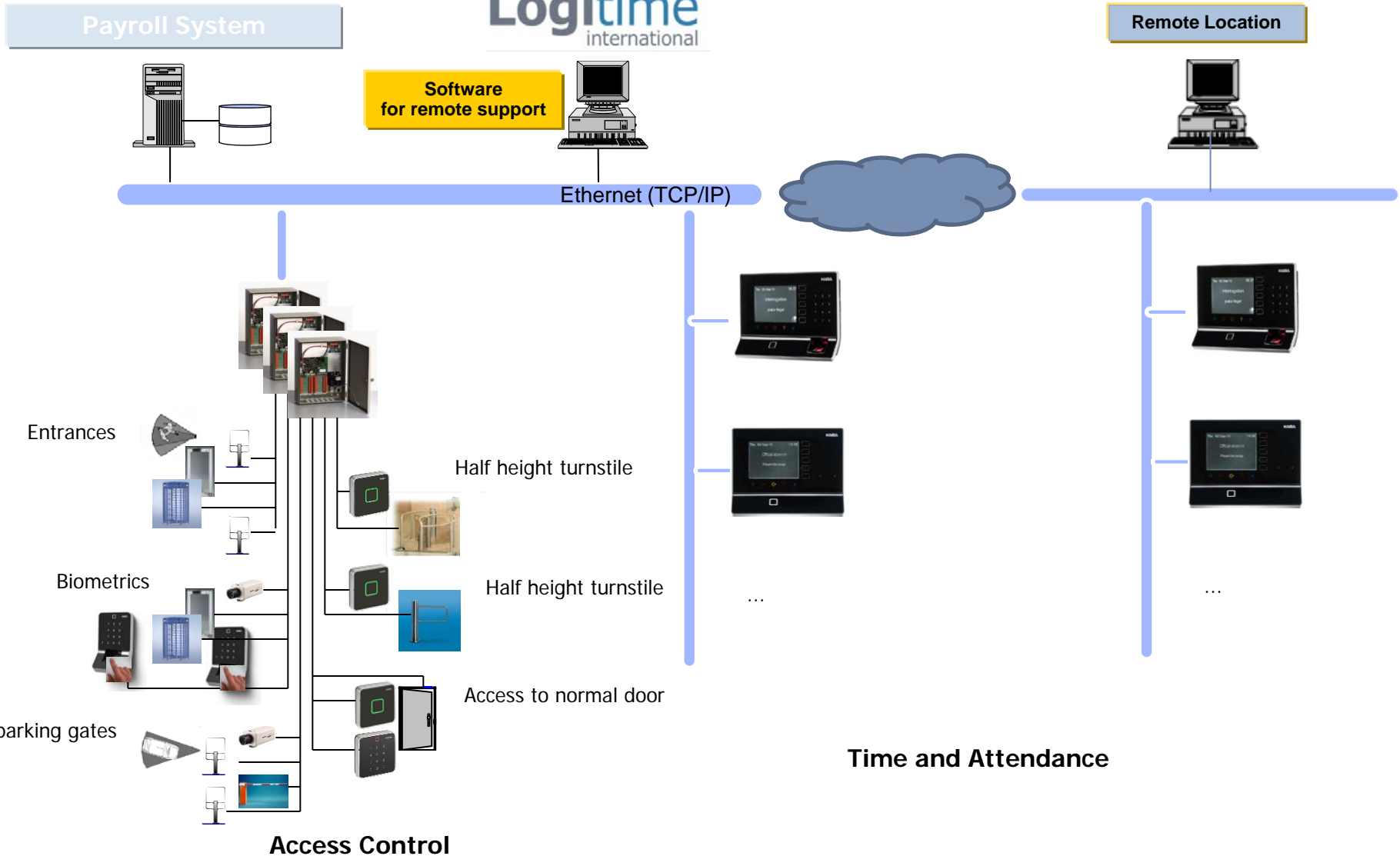

System Configuration for SAP Solution

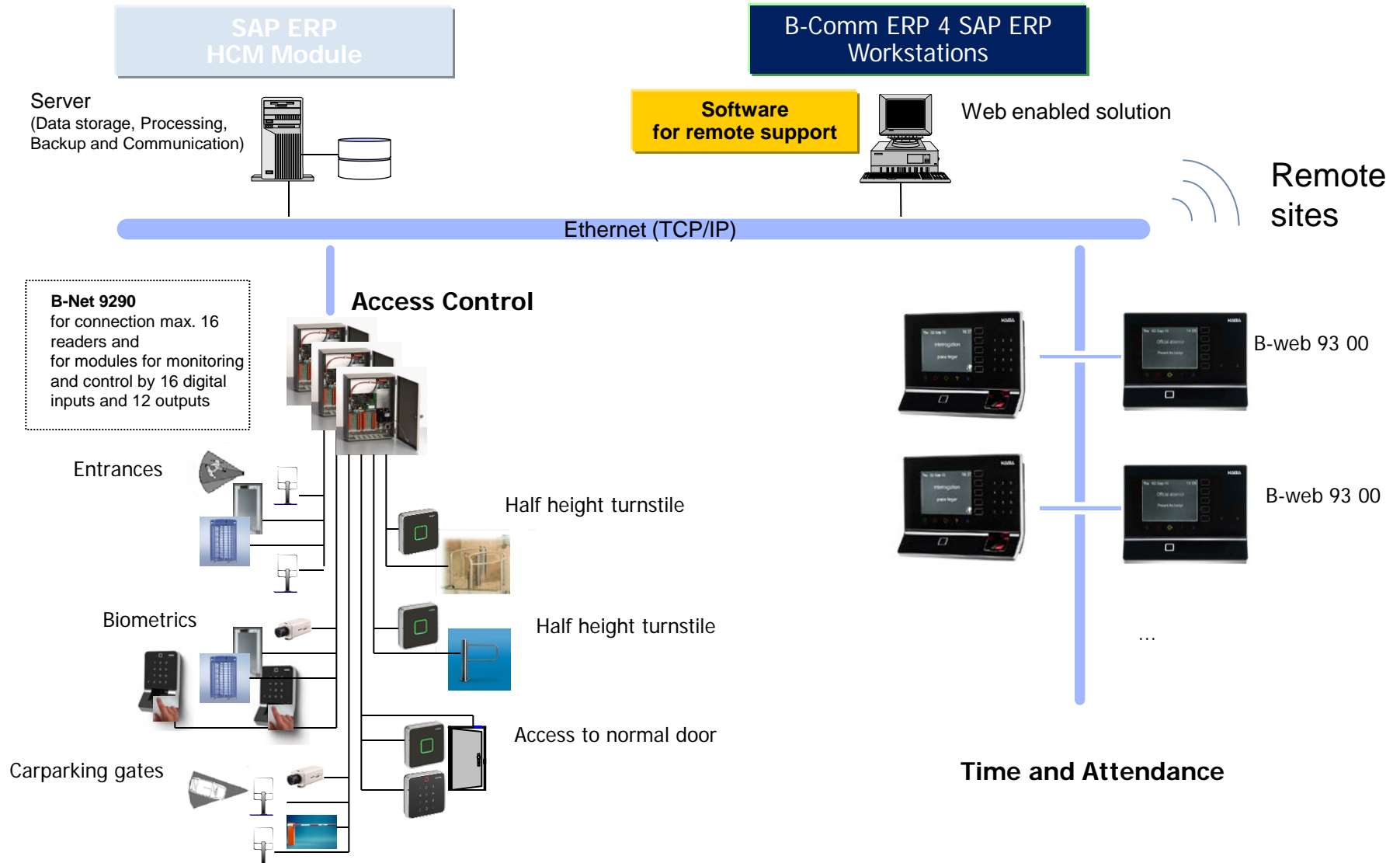

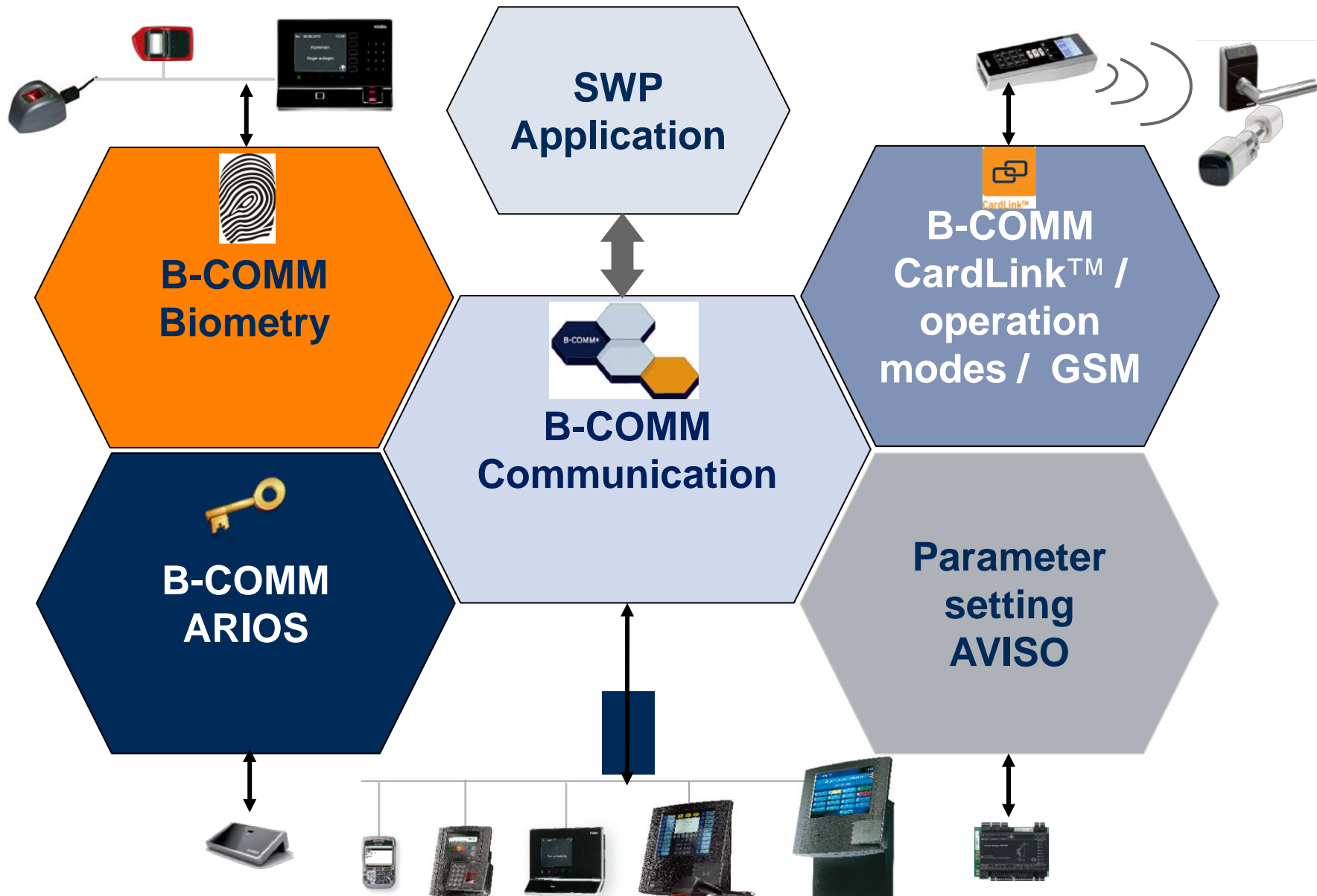

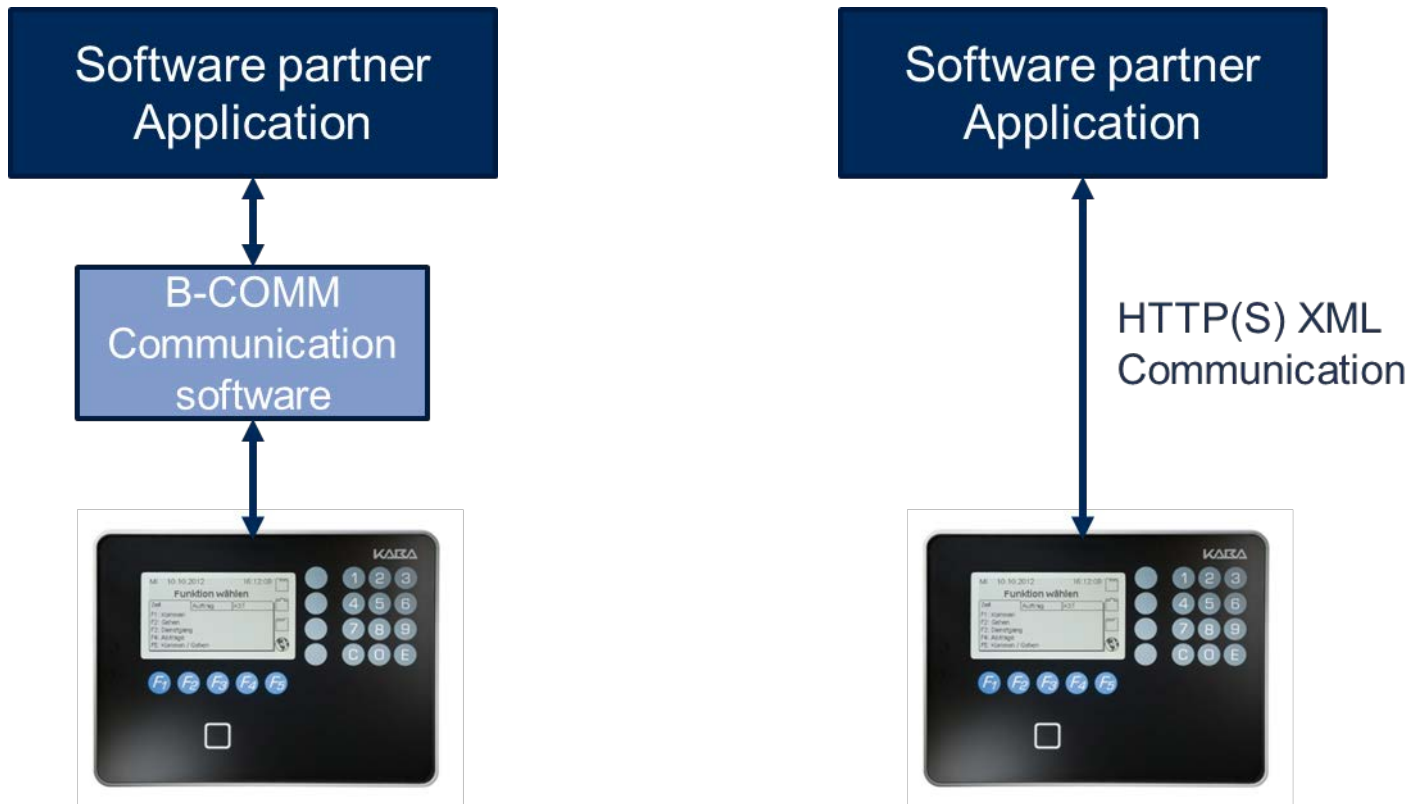

B-Net 92 90

B-Net 92 50

B-web 92 00

Information terminal

B-web 97 00

B-web 96 00

B-web 93 00

Kaba Benzing multitouch

B-Net 95 80

B-Net 95 60

B-web 95 00

Services

B-COMM

B-Net mobile

Peripherals

Compact Reader
B-web 91 10

Biometry Reader
B-web 91 05 FP

B-Net 91 04
B-Net 91 05/05 FP

B-Net 91 20

Digital I/O
Bedanet 90 20

Registration Unit
B-web 90 01 / 90 02

Remote Reader
B-web 91 15

B-Net 90 10

B-web 91 08

c-lever compact
and digital cylinder

Available in three packages

- > B-web 93 20
- > B-web 93 40
- > B-web 93 60

What remains?

- > Compatibility to previous series
- > Same reader connectivity
- > Full biometry range (even enhanced)
- > Various power options
- > Same symbolic
- > Parameter setting options
- > ...



B-web 93xx



- Barcode swipe redlight
- Barcode swipe ifrared
- Magstripe OE 300/4000 track 2
- Other readers on request



Use case for two relays





Apps

- > Standard bookings
- > Vacation/flexitime requests
- > Briefing
- > Visitor registration
- > Time correction
- > Message centre

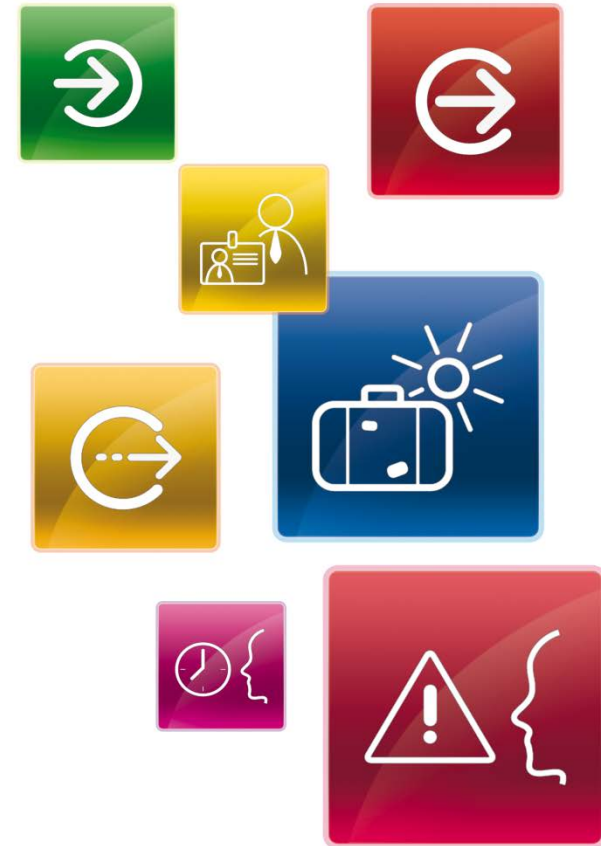

Development never stands still

- > Canteen
- > Surveys
- > Room reservation
- > Personal data record changes
- > Health and security instructions
- > Enterprise news
- > Weather forecasts
- > ...



[The Kaba app shop](#)

www.kaba.com/wfm/apps



Agenda

KABA[®]

- > Kaba EAC (Electronic Access)
- > Kaba WFM (Work Force Management)
- > **Kaba Hardware portfolio**

Kaba exos System (Online AC)

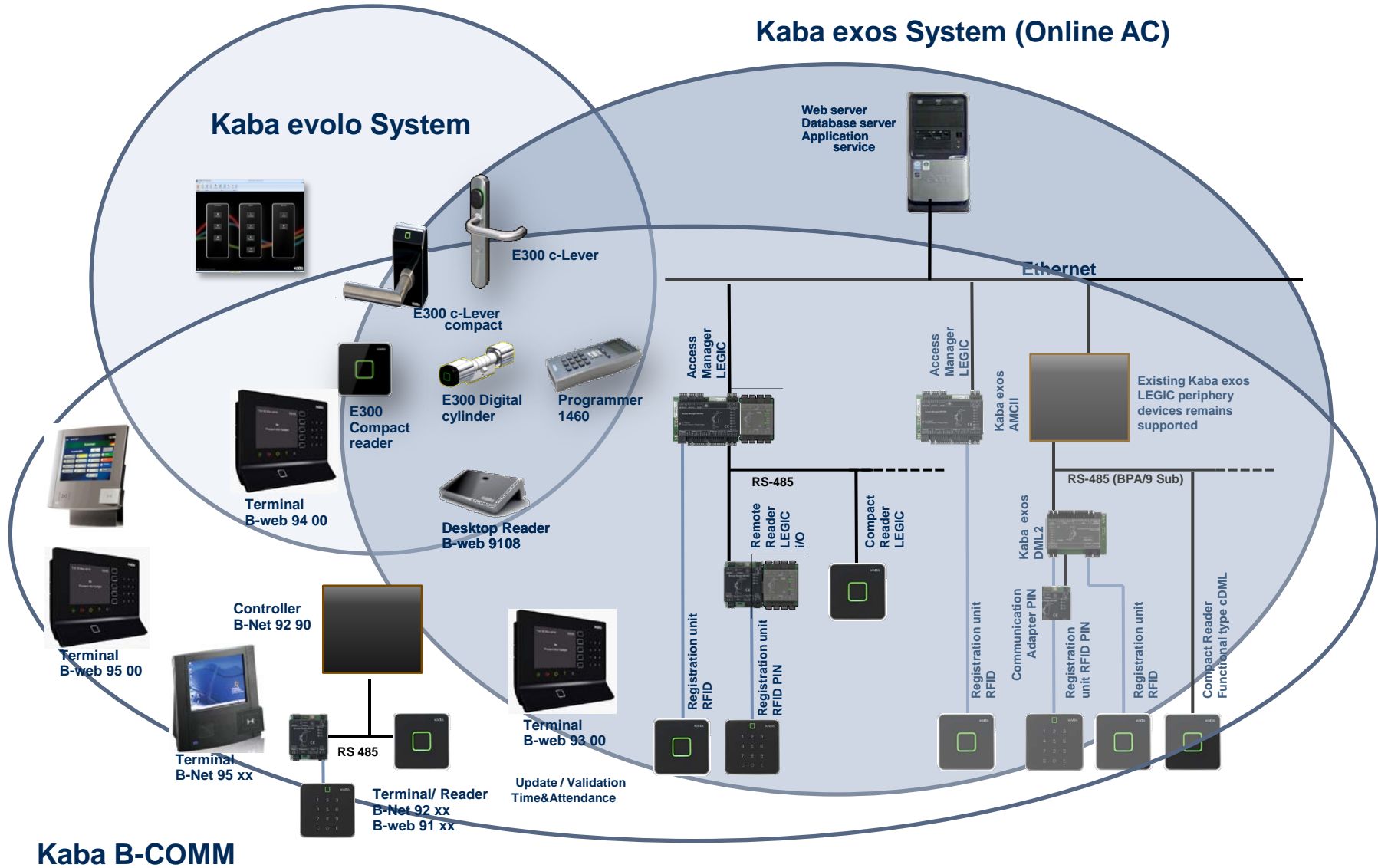

Thank you!

KABA[®]